

Specifications

Nominal torque	35	N.m	<i>ft.lbf</i>	26
Minimal torque	0.33	N.m	<i>ft.lbf</i>	0.25
Coil resistance - 20°C			<i>W</i>	19
Rated current DC			A	1
Rotor inertia	0.79 · 10 ⁻³	kg.m ²	<i>lb.ft²</i>	18.4 · 10⁻³
Weight	4.6	kg	<i>lb</i>	10.14
Heat dissipation continuous sustained depending on external part rotation speed	<i>W</i> *			100 250 340
	(RPM)	0	1000	2000

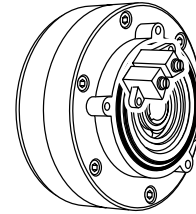

* Heat dissipation is the mechanical power ($P = cw$) maximum allowable.

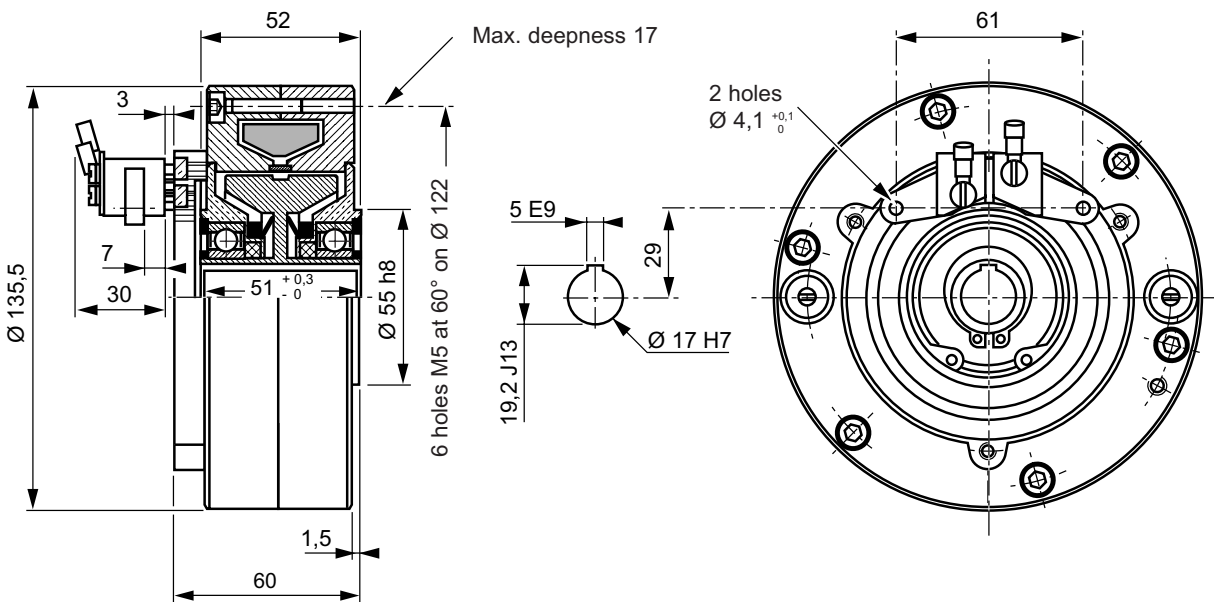

Application Notes

- Mounting must be made without any stress.
Lubricated for life (other internal lubrication not allowed).
The shaft should be lubricated upon assembly, to prevent seizing.
- Low DC current power supply for coil.
- The standard device is designed for horizontal shaft orientation, and a minimal speed of 60 RPM. Maximum speed is 3000 RPM (without exceeding the max. heat dissipation capability).
- For Engineering application, please contact our technical support.
- In normal use, the outside temperature of the device can increase up to 100°C, without damage.

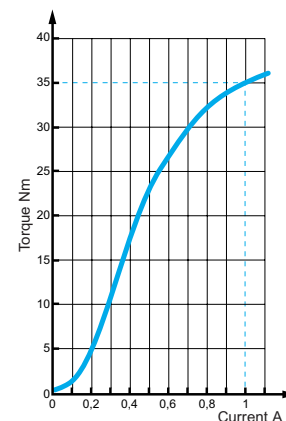

Safety

- If the device is to be used in dusty, humid or corrosive environment, special protection needs to be considered.

Recommended mounting principles

In line mounting

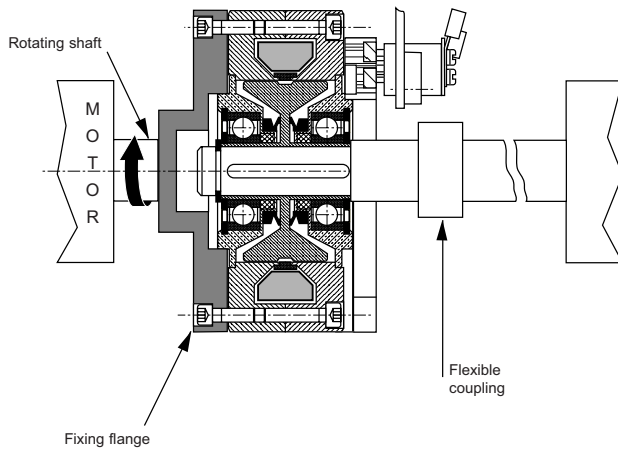

Parallel mounting

